

Simmonsourt Pavilion

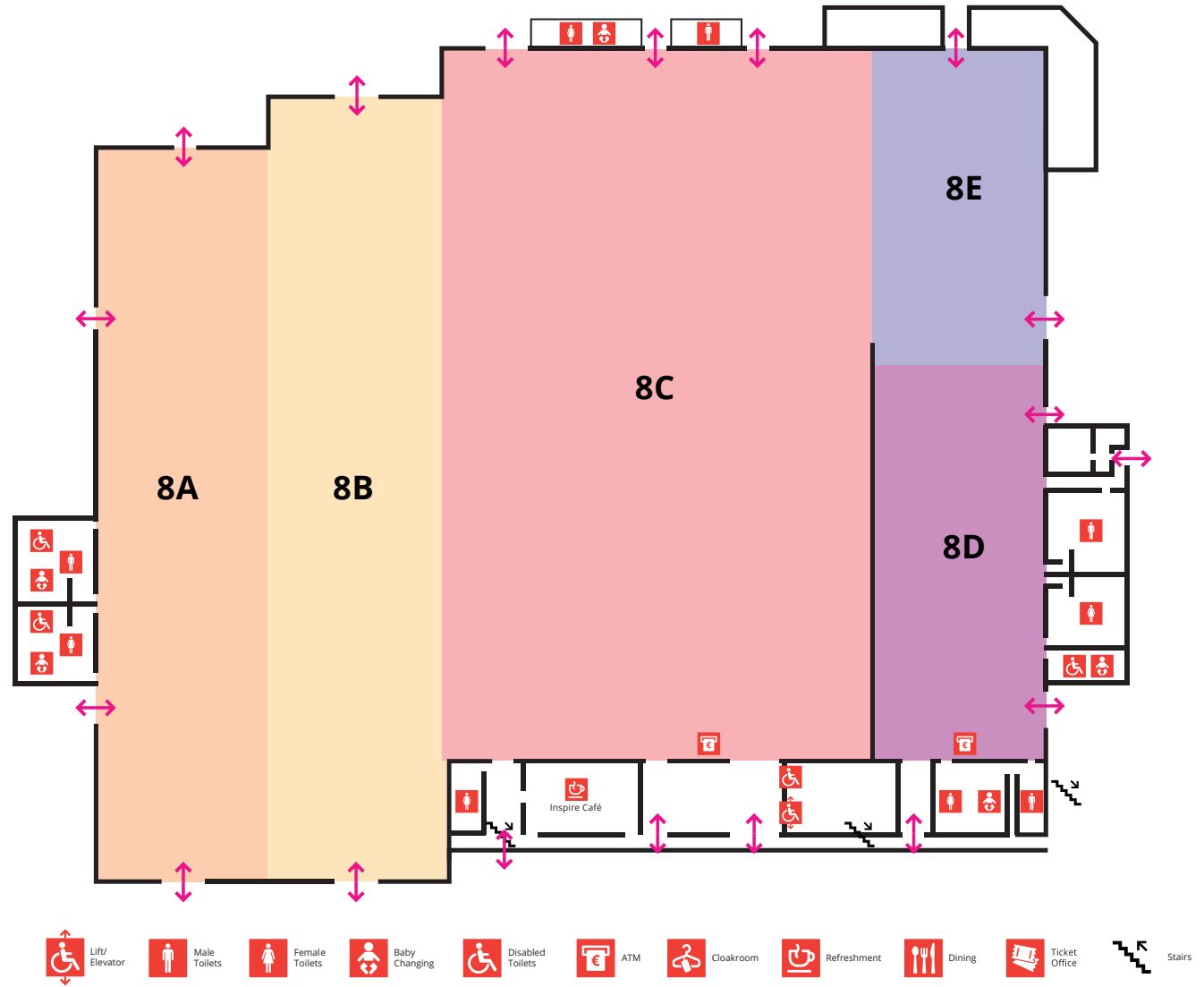

T: +353 (0)1 668 0866 | sales@rds.ie | www.rds.ie/venue-hire



IMPORTANT: The size and location of items such as a staging AV, lighting, bar, buffet tables etc. impact the capacities listed. The figures here are indicative of the maximum capacity in a space. The capacity for your event will depend on your layout and may be less than the figures stated.

Hall	Floor	Area (Sq. M)	Width	Length	Reception	Theatre Style	Dinner Layout	Classroom Style	Exam Style	Board Room Style	Cabaret Style	Height (max)	Height (min)	Floor Loading (Kn/Sq. M)	Electrical Power
Hall 8A (Simmonsourt)	Ground	1,990	21.7m	91.5m	2,600	2,100	1,180	1,224	1,120	n/a	864	9m	6m	50	2 x 160 Amp/3 Phase
Hall 8B (Simmonsourt)	Ground	2,145	22.9m	97.6m	2,800	2,200	1,270	1,310	1,200	n/a	944	9m	6m	50	2 x 160 Amp/3 Phase
Hall 8C (Simmonsourt)	Ground	4,754	53.3m	89.2m	6,300	6,500	2,970	2,880	2,895	n/a	2,186	14m	6m	50	4 x 160 Amp/3 Phase
Hall 8D (Simmonsourt)	Ground	864	21.9m	39.3m	1,150	1,000	600	620	590	n/a	440	6m	n/a	50	1 x 80 Amp/3 Phase
Hall 8E (Simmonsourt)	Ground	1,094	21.9m	49.8m	1,440	740	450	400	460	n/a	280	9m	6m	50	1 x 80 Amp/3 Phase