



Hall 8

Contact: RDS, Ballsbridge, Dublin 4, Ireland.
Tel: +353 1 668 0866
Fax: +353 1 660 4014
Email: info@rds.ie
Web: www.rds.ie

HALL 8A TECHNICAL DETAILS		CAPACITIES	
Gross Area	1,900 Sq m	Reception	2,920
Length	91 m	Theatre	2,350
Width	21 m	Banquet	1,000
Height Max	9 m	Classroom	700
Height Min	6 m	Boardroom	N/A
Floor Loading	50 KN/Sq m		
Electrical Power	2 x 160 Amp/3 Phase		
Main Loading Door			
Height x Width	5.61 m x 5.56 m		

HALL 8B TECHNICAL DETAILS		CAPACITIES	
Gross Area	2,060 Sq m	Reception	3,100
Length	97 m	Theatre	2,500
Width	21 m	Banquet	1,100
Height Max	9 m	Classroom	750
Height Min	6 m	Boardroom	N/A
Floor Loading	50 KN/Sq m		
Electrical Power	2 x 160 Amp/3 Phase		
Main Loading Door			
Height x Width	5.41 m x 5.56 m		

HALL 8C TECHNICAL DETAILS		CAPACITIES	
Gross Area	4,717 Sq m	Reception	7,200
Length	89 m	Theatre	6,500
Width	53 m	Banquet	3,250
Height Max	14 m	Classroom	1,800
Height Min	6 m	Boardroom	N/A
Floor Loading	50 KN/Sq m		
Electrical Power	4x160 Amp/3 Phase		
Main Loading Door			
Height x Width	6.25 m x 4.32 m		

HALL 8D TECHNICAL DETAILS		CAPACITIES	
Gross Area	1,029 Sq m	Reception	1,500
Length	49 m	Theatre	1,000
Width	21 m	Banquet	650
Height Max	6 m	Classroom	330
Height Min	N/A	Boardroom	N/A
Floor Loading	50 KN/Sq m		
Electrical Power	1 x 80 Amp/3 Phase		
Main Loading Door			
Height x Width	5.56 m x 5.59 m		

HALL 8E TECHNICAL DETAILS		CAPACITIES	
Gross Area	840 Sq m	Reception	1,300
Length	40 m	Theatre	800
Width	21 m	Banquet	500
Height Max	9 m	Classroom	300
Height Min	6 m	Boardroom	N/A
Floor Loading	50 KN/Sq m		
Electrical Power	1 x 80 Amp/3 Phase		
Main Loading Door			
Height x Width	5.56 m x 5.59 m		

The overall useable electrical power in Simmonscourt is 800Amp /3 Phase.

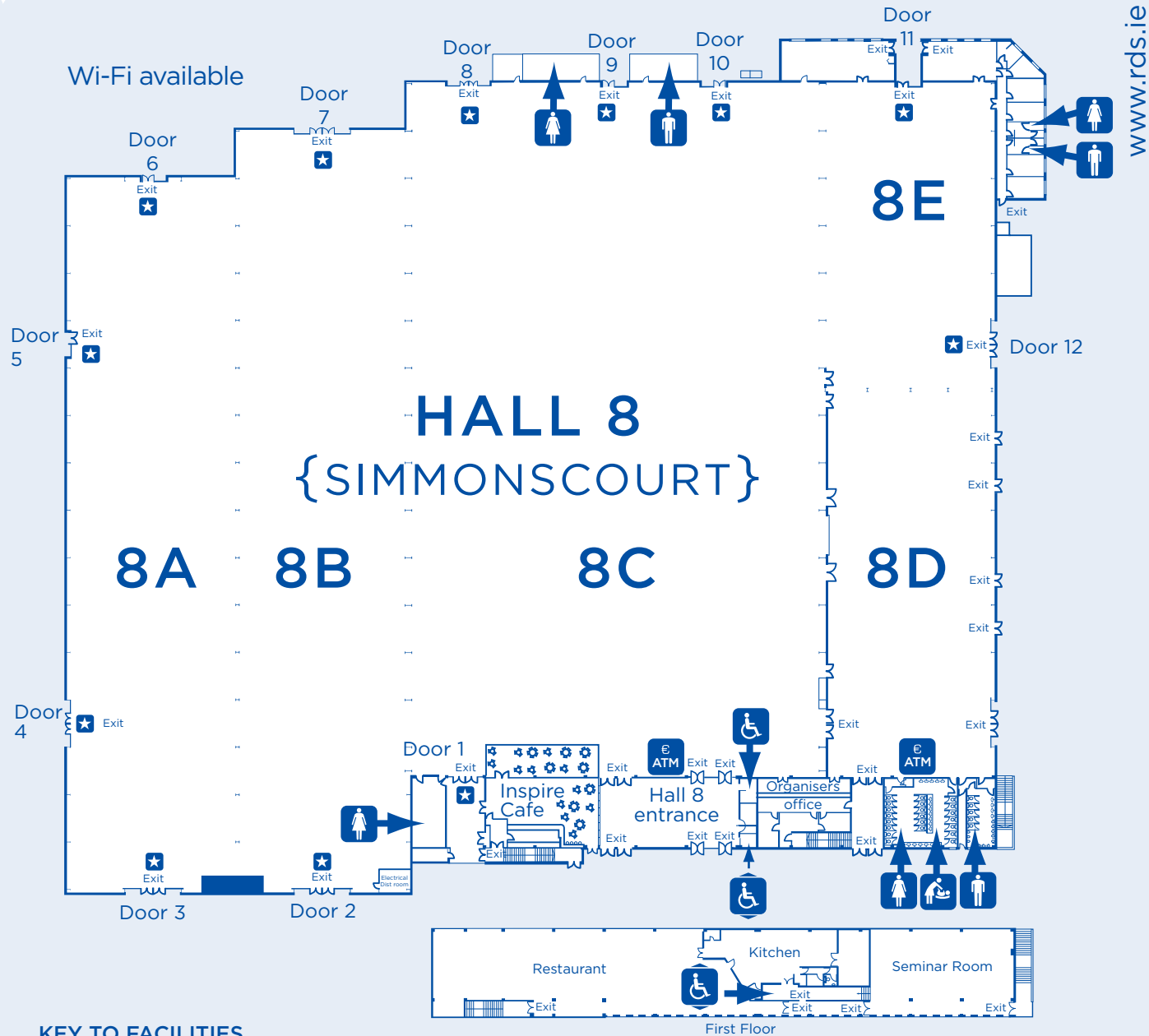

KEY TO FACILITIES

Male toilets	Accessible lift	Loading Doors	Baby change facilities
Female toilets	ATM	Accessible toilets	